

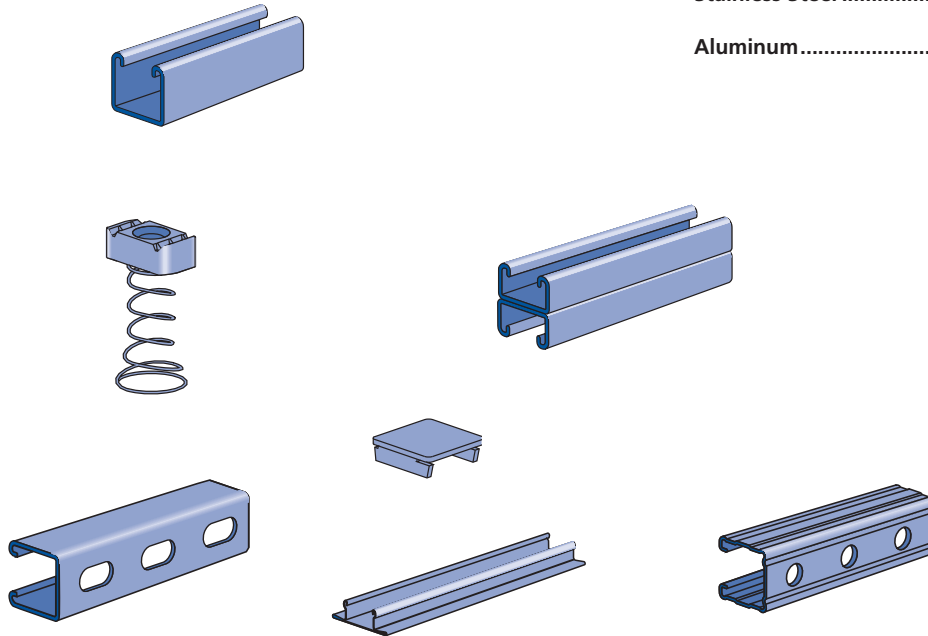

SPECIAL METALS

Stainless Steel211-212
 Aluminum.....213-214



MATERIAL

STAINLESS STEEL

Channels: ASTM A 240 (Type 304)
 Sintered nuts: ASTM B783 (Type SS316N1-25)
 Fittings:
 ASTM A240 (Type 304) or ASTM A276 (Type 304)
 Type 316 stainless also available for most products.
 Contact factory for specific material availability.

ALUMINUM

Channels (Extruded): ASTM B221 (Type 6063-T6)
 Fittings: ASTM B209 (Type 1100F or Type 5052-H32)
 Nuts: ASTM B221 (Type 6063-T5)

LOAD DATA (BEAM & COLUMN)

To determine maximum allowable beam and column load-
 ing for channels in this section, multiply the load data in
 the appropriate mild steel channel sections of this catalog
 by the following factors:

Channel Material	Beam Load % Factor	Column Load % Factor
Extruded Aluminum	33%	33%
Stainless Steel	100%	100%

LOAD DATA (SLIP & PULL OUT)

EXTRUDED ALUMINUM

To determine nut slip resistance, multiply load data
 for appropriate nut by 75%. To determine nut
 pull-out load, multiply load data for appropriate
 nut by 50%.

STAINLESS STEEL

For design assistance, consult Unistrut customer
 engineering.

PRODUCT AVAILABILITY

Most fittings and channels shown in this catalog, are
 available in aluminum or stainless steel. Consult factory
 for ordering information.

DIMENSIONS

Imperial dimensions are illustrated in inches. Metric dimen-
 sions are shown in parenthesis or as noted. Unless noted,
 all metric dimensions are in millimeters and rounded to
 one decimal place.



1 1/2" System

P1000 Series (12 gauge)



P1000 SS
Pg 211



P1001 SS
Pg 211

P1100 Series (14 gauge)



P1100 SS
Pg 211



P1101 SS
Pg 185

P3000 Series (12 gauge)



P3000 SS
Pg 211

1 1/4" System

P3300 Series (12 gauge)



P3300 SS
Pg 211



P3301 SS
Pg 211

P4000 Series (16 gauge)



P4000 SS
Pg 211

P6000 Series (19 gauge)



P6000 SS
Pg 211

1 3/16" System

P7000 Series (19 gauge)



P7000 SS
Pg 211

Closure Strips and End Caps

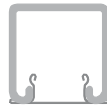

P1184 SS
Pg 186



P3184 EA
Pg 214



P1280 EA, P4280 EA,
P5580 EA Pg 214

Fiberglass System

Stainless Steel Channel Nuts



P1006 U - P1010U
Pg 212



P4006 U - P4010
Pg 212



P5506 U - P5510U
Pg 212



P4006T, P4008UT
Pg 212



A1006 SS, A1008 SS
Pg 212



A4006 SS, A4008 SS
Pg 212

Special Metals

Prime Angle

Extruded Aluminum Channels



P1000 EA
Pg 213



P1001 EA
Pg 213



P4000 EA
Pg 213



P4001 EA
Pg 213



P5500 EA
Pg 213



A1000 EA
Pg 213



A4000 EA
Pg 213



A4001 EA
Pg 214

Metal Grating

Roofwalk

Index



P6000 EA
Pg 214



P6001 EA
Pg 214



P7000 EA
Pg 214



P7001 EA
Pg 214

P1000 SERIES

P1000 SS

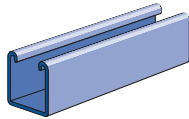

Wt/100 Ft: 190 Lbs (283 kg/100m)

P1001 SS

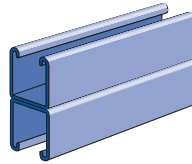

Wt/100 Ft: 380 Lbs (566 kg/100m)

P1000HS SS

9/16" (14.3) Dia. Holes
1 7/8" (47.6) on Center

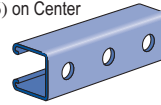

Wt/100 Ft: 185 Lbs (275 kg/100m)

P1000T SS

Slots are
1 1/8" (28.6) x 9/16" (14.3)
2" (50.8) on Center

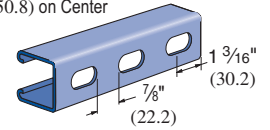

Wt/100 Ft: 185 Lbs (275 kg/100m)

P1100 SERIES

P1100 SS

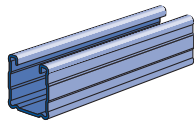

Wt/100 Ft: 142 Lbs (211 kg/100m)

P1101 SS

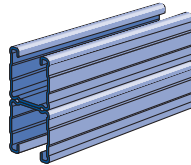

Wt/100 Ft: 284 Lbs (422 kg/100m)

P1100HS SS

9/16" (14.3) Dia. Holes
1 7/8" (47.6) on Center

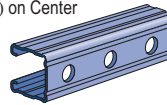

Wt/100 Ft: 136 Lbs (202 kg/100 m)

P1100T SS

Slots are
1 1/8" (28.6) x 9/16" (14.3)
2" (50.8) on Center

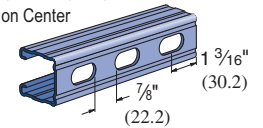

Wt/100 Ft: 136 Lbs (202 kg/100m)

P3000 SERIES

P3000 SS

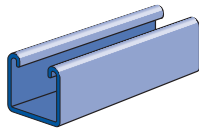

Wt/100 Ft: 170 Lbs (253 kg/100m)

P3000HS SS

9/16" (14.3) Dia. Holes
1 7/8" (47.6) on Center

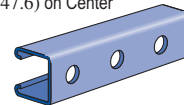

Wt/100 Ft: 165 Lbs (112 kg/100m)

P3000T SS

Slots are
1 1/8" (28.6) x 9/16" (14.3)
2" (50.8) on Center

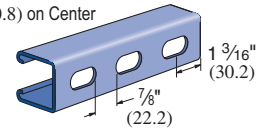

Wt/100 Ft: 165 Lbs (112 kg/100m)

P3300 SERIES

P3300 SS

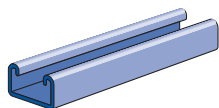

Wt/100 Ft: 135 Lbs (201 kg/100m)

P3301 SS

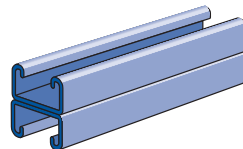

Wt/100 Ft: 270 Lbs (402 kg/100m)

P3300HS SS

9/16" (14.3) Dia. Holes
1 7/8" (47.6) on Center

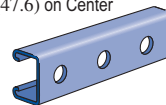

Wt/100 Ft: 130 Lbs (193 kg/100m)

P3300T SS

Slots are
1 1/8" (28.6) x 9/16" (14.3)
2" (50.8) on Center

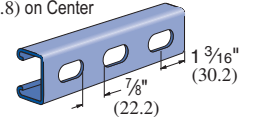

Wt/100 Ft: 130 Lbs (193 kg/100m)

P4000 SERIES

P4000 SS

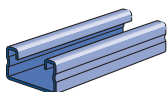

Wt/100 Ft: 82 Lbs (122 kg/100m)

P4000HS SS

9/16" (14.3) Dia. Holes
1 7/8" (47.6) on Center

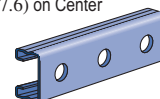

Wt/100 Ft: 79 Lbs (110 kg/100m)

P4000T SS

Slots are
1 1/8" (28.6) x 9/16" (14.3)
2" (50.8) on Center

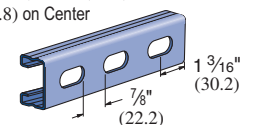

Wt/100 Ft: 79 Lbs (110 kg/100m)

P6000 SS

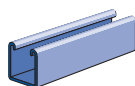

Wt/100 Ft: 37 Lbs (55 kg/100m)

P7000 SS

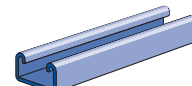

Wt/100 Ft: 36 Lbs (54 kg/100m)



P1184 SS

CLOSURE STRIP

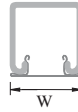
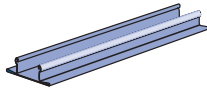

Standard length 10 Ft.
Material: Stainless steel type 304.

Part Number	Use With Channel	"W" In (mm)	Wt/100 Ft Lbs (kg/m)
P1184 SS	P1000		
	P1100	1½"	27
	P3300	41.3	40.2
	P4000		

CHANNEL NUT WITH SPRING— FOR USE WITH 1¼" CHANNEL

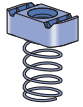
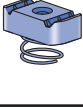
	Part number	Nut Size Thread	Wt/100 pcs Lbs (kg)	Use With
	A1006-1420 SS	1¼" -20	6 (2.7)	A1000
A1008 SS	3⁄8" -16	6 (2.7)		
	Part number	Nut Size Thread	Wt/100 pcs Lbs (kg)	Use With
	A4006-1420 SS	1¼" -20	5 (2.3)	A3300, A4000
A4008 SS	3⁄8" -16	5 (2.3)		

* All Springs are Pre-Galvanized

CHANNEL NUT WITH SPRING – FOR USE WITH 1½" CHANNEL

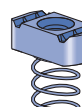
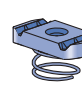
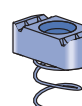
	Part number	Nut Size Thread	Wt/100 pcs Lbs (kg)	Use With 1½" Channel
	P1006U-1420 SS	¼"	20 7 (3.2)	P1000, P1100, P2000, P3000
	P1008U SS	3⁄8"	16 10 (4.5)	
	P1010U SS	½"	13 12 (5.4)	
	Part number	Nut Size Thread	Wt/100 pcs Lbs (kg)	Use With 1½" Channel
	P4006U-1420 SS	¼"	20 7 (3.2)	P3300, P4000, P4100
	P4008 SS	3⁄8"	16 9 (4.1)	
P4010 SS	½"	13 9 (4.1)		
	Part number	Nut Size Thread	Wt/100 pcs Lbs (kg)	Use With 1½" Channel
	P5506U-1420 SS	¼"	20 7 (3.2)	P5500
	P5508U SS	3⁄8"	16 10 (4.5)	
P5510U SS	½"	13 10 (4.5)		

* All Springs are Pre-Galvanized

The letter "U" in Part number = Sintered type 316 stainless steel

CHANNEL NUT WITHOUT SPRINGS – FOR USE WITH 1½" CHANNEL

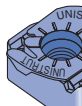
	Part number	Nut Size Thread	Wt/100 pcs Lbs (kg)	Use With 1½" Channel
	P4006T-1420 SS	¼"	20 7 (3.2)	P1000, P1100, P2000, P3000, P5500
P4008UT SS	3⁄8"	16 12 (5.4)		

The letter "U" in Part number = Sintered type 316 stainless steel

Note

Most fittings, as shown in this catalog are available in stainless steel or aluminum. It is recommended that stainless steel channel nuts be used with aluminum channels.

P1000 EA

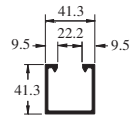
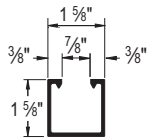

 When used with P3184 EA.

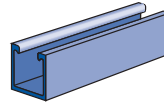

Wt/100 Ft: 76 Lbs (113 kg/100 m)
Aluminum Type 6063-T6
Nominal Thickness .109" (2.8mm)

P1001 EA

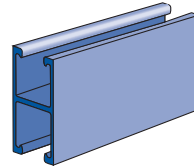
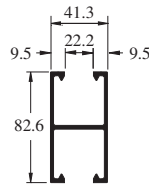
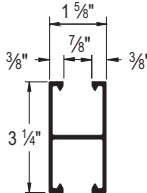

Wt/100 Ft: 134 Lbs (199 kg/100 m)
Aluminum Type 6063-T6
12 Gauge Nominal Thickness .109" (2.8mm)

P4000 EA

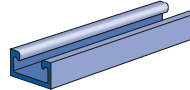
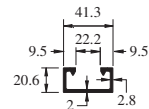
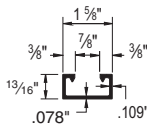

Wt/100 Ft: 45 Lbs (67 kg/100 m)
Aluminum Type 6063-T6
Nominal Thickness .078" (2.0mm)

P4001 EA

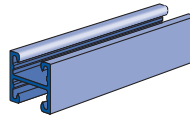
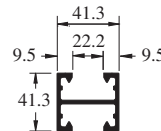
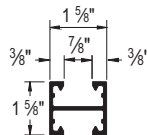

Wt/100 Ft: 66 Lbs (98 kg/100 m)
Aluminum Type 6063-T6
Nominal Thickness .078" (2.0mm)

P5500 EA

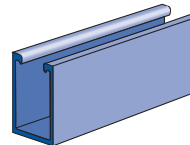
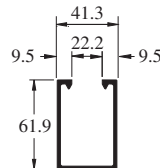
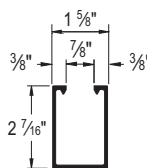

Wt/100 Ft: 97 Lbs (144 kg/100 m)
Aluminum Type 6063-T6
Nominal Thickness .109" (2.8mm)

A1000 EA

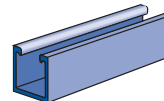
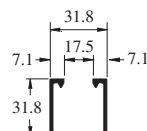
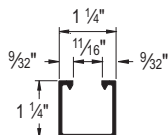

Wt/100 Ft: 40 Lbs (60 kg/100 m)
Aluminum Type 6063-T6
Nominal Thickness .075" (1.9mm)

A4000 EA

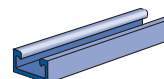
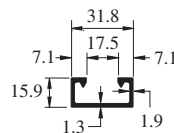
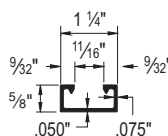

Wt/100 Ft: 25 Lbs (37 kg/100 m)
Aluminum Type 6063-T6
12 Gauge Nominal Thickness .050" (1.3mm)
Standard Length 16 Ft.



1 1/2" System

A4001 EA

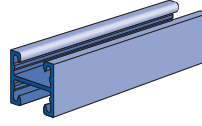
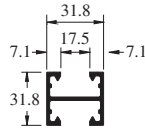
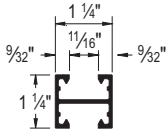

Wt/100 Ft: 40 Lbs (60 kg/100 m)
Aluminum Type 6063-T6
Nominal Thickness .078" (2.0mm)
Standard Length 16 Ft.

1 1/4" System

P6000 EA

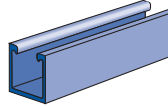
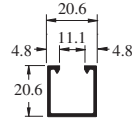
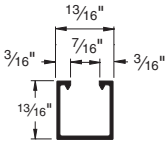

Wt/100 Ft: 12 Lbs (18 kg/100 m)
Aluminum Type 6063-T6
Nominal Thickness .040" (1.0mm)
Standard Length 16 Ft.

1 3/16" System

P6001 EA

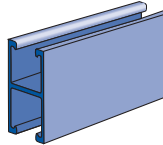
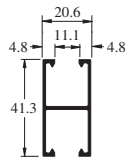
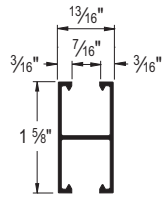

Wt/100 Ft: 20 Lbs (30 kg/100 m)
Aluminum Type 6063-T6
Nominal Thickness .040" (1.0mm)
Standard Length 16 Ft.

Fiberglass System

P7000 EA

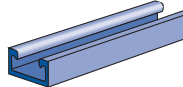
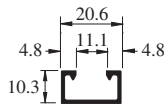
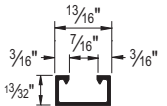

Wt/100 Ft: 9 Lbs (13 kg/100 m)
Aluminum Type 6063-T6
Nominal Thickness .040" (1.0mm)
Standard Length 10 Ft.

Special Metals

P7001 EA

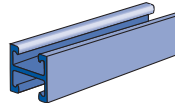
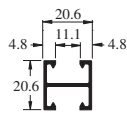
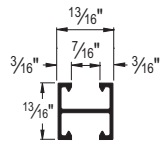

Wt/100 Ft: 17 Lbs (25 kg/100 m)
Aluminum Type 6063-T6
12 Gauge Nominal Thickness .040" (1.0mm)
Standard Length 10 Ft

Prime Angle

Metal Grating

P3184 EA

CLOSURE STRIP

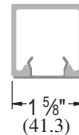
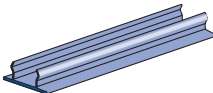

Wt/100 Ft: 21 Lbs (31 kg/100 m)
Aluminum Type 6063-T6
Standard Length 10 Ft

Roofwalk

Index

P1280 EA, P4280 EA, P5580 EA

END CAPS

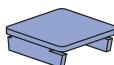

Part Number	Use With Channel	Wt/100 Ft Lbs(kg/m)
P1280 EA	P1000 EA	3.5 (1.6)
P4280 EA	P4000 EA	1.5 (0.7)
P5500 EA	P5500 EA	4.9 (2.2)